

CUST. MODEL:	REF:
CUST. P/N:	DWG FILE:

DESCRIPTION CONTROL			
REV.	DESC.	DATE.	APP.
1.0			

SPECIFICATION:

1. VOLTAGE RATING: 300VAG(rms).
2. CURRENT RATING: 3 AMP CONTINUOUS
3. DIELECTRIC STRENGTH 1000VAC
4. CONTACT RESISTANCE: 10 M Ohm min
5. INSULATION RESISTANCE: 5000 M Ohm min

Male

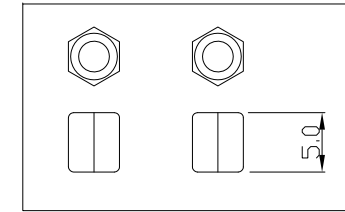
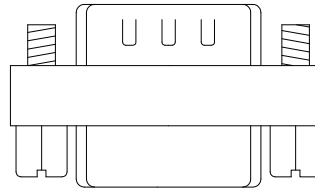
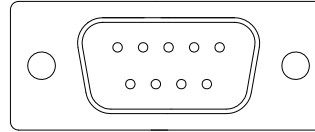

#4-40 NUT

#4-40 screw

9PIN MALE

9PIN FEMALE

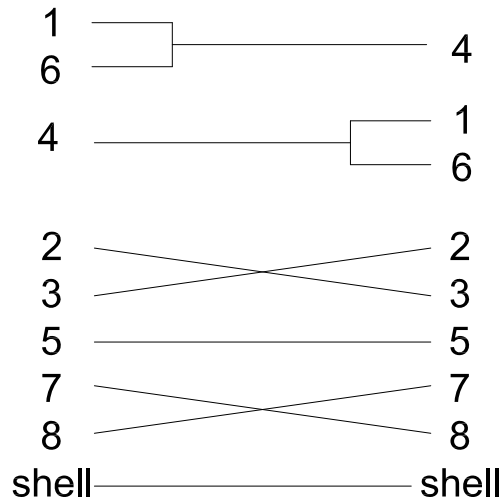

Female

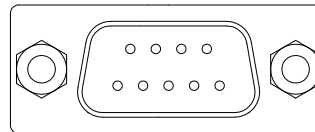

UNLESS OTHERWISE SPECIFIED SURFACE FINISH ALL OVER TOLERANCES mm METRIC X. = ±0.5 .X = ±0.30 .XX = ±0.25 .XXX = ±0.15	DRAW:	DATE:	TITLE:
	BEN	04/18/12	NULL GC CONN
	CHECK:	APPROVE:	MODEL CODE:
	KEVIN	TONY	NG003-16C121
			誠州電子有限公司 Sincere State Electronics Co.,Ltd.

NO.	DESCRIPTION	QTY
-----	-------------	-----